

GARDEN PLANS

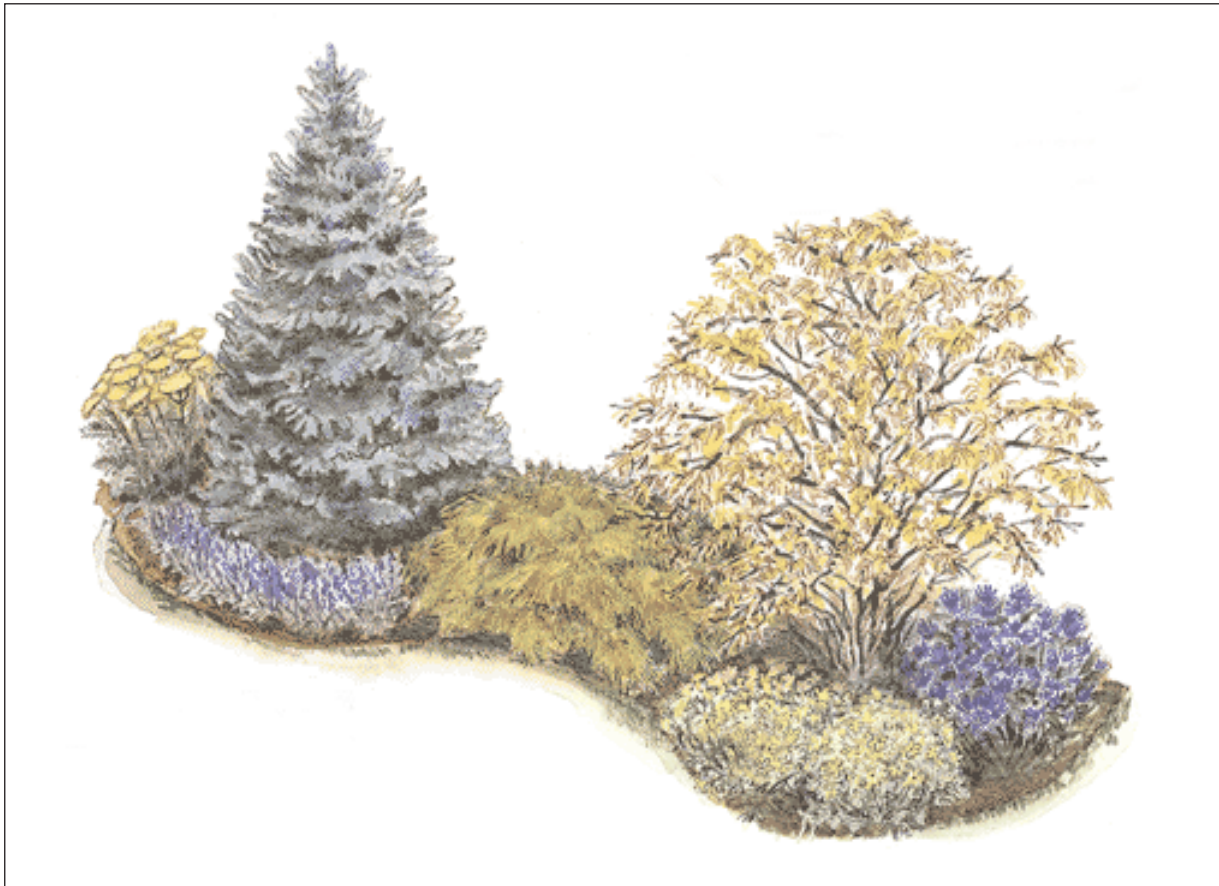

Property Line Garden

THIS STYLISH BORDER FEATURES A SOPHISTICATED COLOR PALETTE.

The perennials in the design, chosen for their long season of bloom, offer flowers in violet-blue and yellow shades. Evergreen shrubs in silver-blue and bright chartreuse-gold keep the color scheme going year-round. Site the garden along a property line, where it will impart a sense of enclosure to your yard without blocking the view; or plant it against a fence or wall. The three types of bulbs at the bottom of the list may be added to the garden, if you like, for early spring color. The plants in this garden need a sunny exposure.

1 SQUARE = 1 FOOT

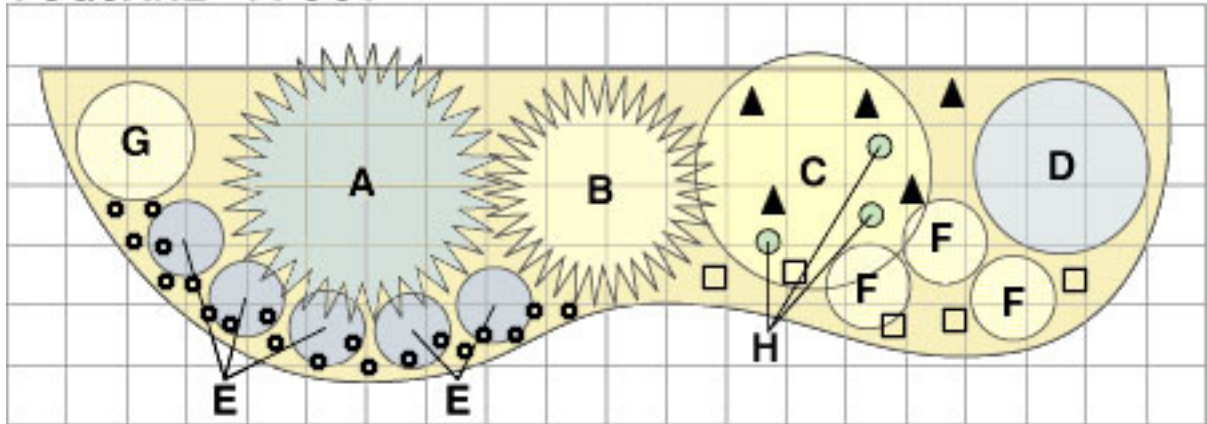

PLANT LIST

A Fat Albert Blue Spruce (*Picea pungens* 'Fat Albert') (1)
Zones 2-8. Compact form of blue spruce, evergreen. 10' tall.

ALTERNATIVE PLANTS

Pyramidal Arborvitae (*Thuja occidentalis* 'Pyramidalis')
Zones 4-9. Bright green, narrow evergreen. 12'-25' tall.

B Saybrook Gold Juniper (*Juniperus chinensis* 'Saybrook Gold') (1)
Zones 4-9. Horizontal evergreen with feathery gold branching. 2'-3' tall.

ALTERNATIVE PLANTS

Armstrong Juniper (*Juniperus chinensis* 'Armstrong')
Zones 4-9. Compact, spreading evergreen, bright green foliage. 2'-3' tall.

Summer Wine Daylily (*Hemerocallis* 'Summer Wine')
Zones 2-9. Maroon flowers with yellow throats. 28" tall.

C Vernal Witchhazel (*Hamamelis vernalis*) (1)
Zones 5-8. Upright shrub, yellow ribbonlike blooms in February/March, brilliant yellow fall foliage. 10' tall.

ALTERNATIVE PLANTS

Chinese Lilac (*Syringa x chinensis*)
Zones 4-8. Upright, vigorous grower, small leaves, lilac-purple flowers in spring. 10' tall.

D Dark Knight Bluebeard (*Caryopteris x clandonensis* 'Dark Knight') (1)
Zones 5-8. Silver-green foliage, dark blue blooms in late summer. 30" tall.

ALTERNATIVE PLANTS

Dwarf Arctic Blue Leaf Willow (*Salix purpurea* 'Nana')
Zones 4-8. Finely textured, bluish foliage, purplish twigs in winter. 3'-4' tall.

E Catmint (*Nepeta x faassenii*) (5)
Zones 4-7. Lavender-blue flowers in June/July, gray foliage. 12" tall.

ALTERNATIVE PLANTS

American Germander (*Teucrium canadense*)
Zones 5-9. Dark shiny green leaves, rose flowers in summer. 12" tall.

F Moonbeam Coreopsis (*Coreopsis verticillata* 'Moonbeam') (3)
Zones 3-9. Creamy yellow flowers all summer, ferny foliage. 18" tall.

ALTERNATIVE PLANTS

Goldsturm Black-Eyed Susan (*Rudbeckia fulgida* 'Goldsturm')
Zones 4-8. Bright golden flowers with dark center cones. 24" tall.

G Coronation Gold Yarrow (*Achillea* 'Coronation Gold') (1)
Zones 3-9. Flat-topped clusters of golden-yellow flowers, gray lacy foliage. 36" tall.

ALTERNATIVE PLANTS

Hyperion Daylily (*Hemerocallis* 'Hyperion')
Zones 2-9. Lemon yellow flowers, nice fragrance. 42" tall.

H Husker Red Beard Tongue (*Penstemon digitalis* 'Husker Red') (3)
Zones 4-8. Mahogany foliage, white flowers tinted pink. 30" tall.

OPTIONAL PLANTS

● **Mixed Dutch Crocus** (*Crocus vernus*) (20)
Zones 4-8. Goblet-shaped flowers in early spring. Colors include purple, yellow, white. 4"-6" tall.

▲ **Redhill Daffodil** (*Narcissus* 'Redhill') (5)
Zones 3-7. White flowers with red-orange cups in mid-spring. 16" tall.

□ **Red Riding Hood Tulip** (*Tulipa greigii* 'Red Riding Hood') (5)
Zones 3-8. Reliable, sturdy red flowers in early spring. Mottled foliage. 6"-8" tall.

GET \$5 OFF!

USE CODE **BHGSD** AT CHECKOUT!

COUPON EXPIRES 12/31/2012.

Get \$5.00 off your purchase of \$50
in the BHG Garden Store. Use code
BHGSD at checkout for your discount!

Shop Now



Rare, award
winning!
Shows 3 colors
at once.

Vanilla Strawberry™ Hydrangea

Tri-colored award-winning hydrangea!
New flower heads continue to open
into late summer. Grows 6-7 feet tall.

Buy Now



Our editor's
favorite!
Reblooming &
compact!

Reblooming Lilac

Bloomerang® Lilac fills out with purple-
pink, sweetly scented blooms in May
and flowers throughout summer.

Buy Now



Very rare,
unique, and
compact!

Wedding Gown Hydrangea

Each fully double, white flower head of
this Lacecap Hydrangea looks like a
mini bridal bouquet.

Buy Now



The world's
ONLY pink
blueberry!

Pink Lemonade Blueberry

Be one of the first to grow pink
blueberries, packed with powerful
antioxidants and a mild, sweet flavor!

Buy Now